

Kids Safe Mode on Sky Q Box

Controls & Settings guide

Kids Safe Mode on Sky Q box allows parents to keep children from viewing inappropriate content when watching TV.



What do I need?

Sky Q box and a Sky PIN to activate the feature.

Restrictions you can apply



Browser Access



Inappropriate content



Timer

Step by Step instructions

1. Setting up Safe mode

To turn kids safe mode on and only access kid-friendly shows and recordings, open your browser on your Sky box.



2. Setting up safe mode

Go to the Kids section and you will see an option to select 'Safe Mode'. Swipe right and press select.

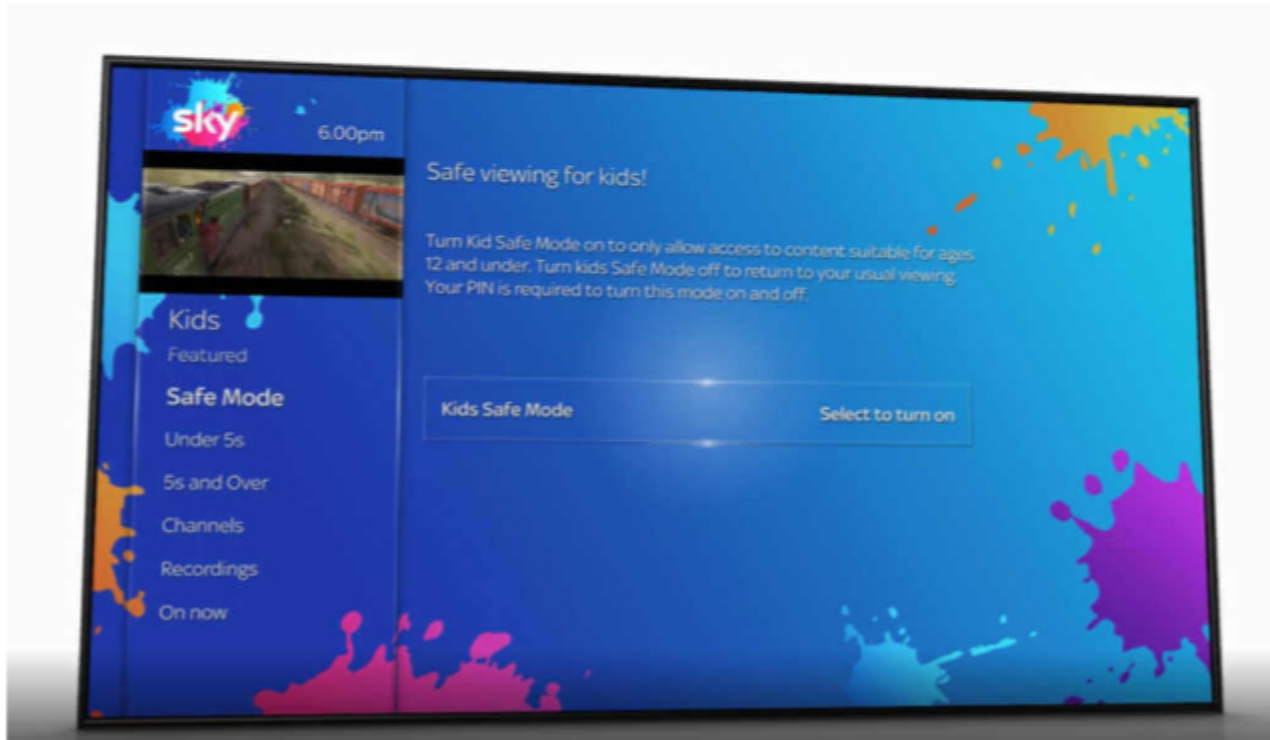

3. Setting up Safe mode

Once prompted, enter your Sky PIN to confirm to turn safe mode on or off. Once you have done this your Sky Box will be locked and only allow your child access to the Kids section until you have turned Kids Mode off.

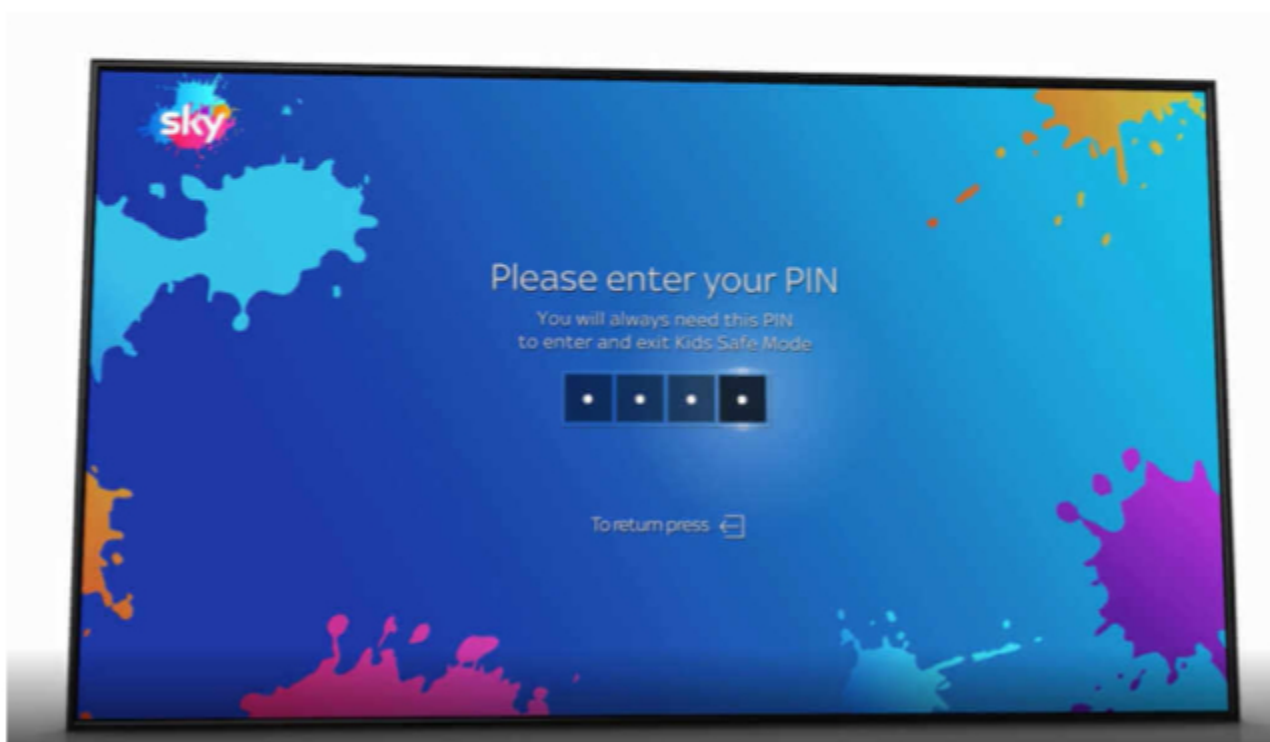

4. Setting up Family settings

As well as Safe mode, you can use 'Family setting' to turn on PIN-protection for any rated shows you watch before the watershed.

Press Home on your Sky Q remote

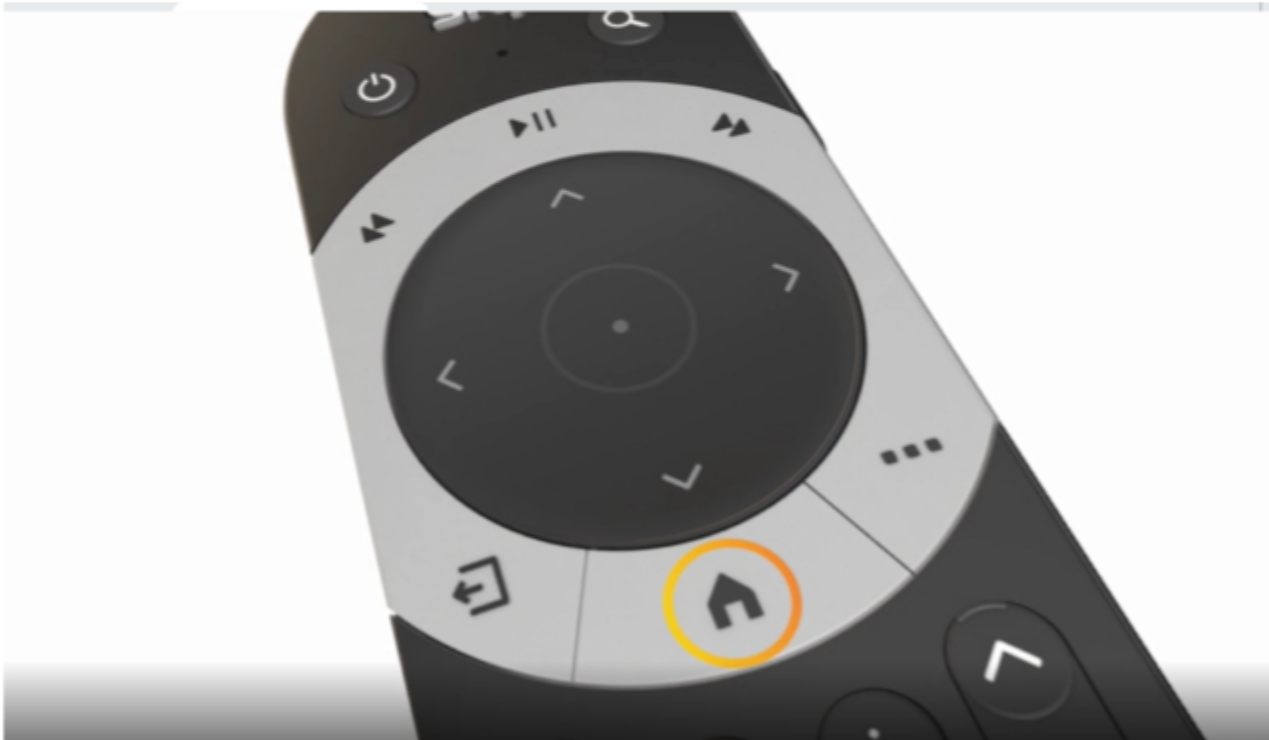

5. Setting up Family settings

Then, select Settings, then Parental.

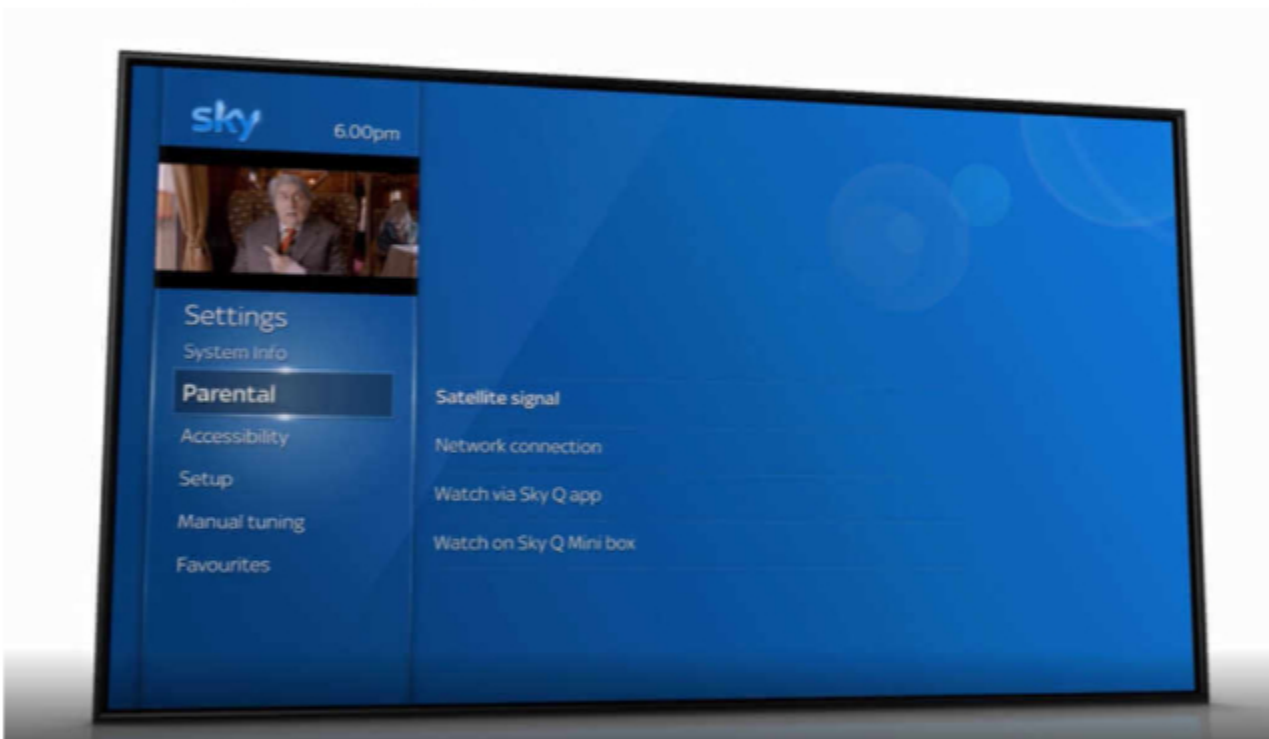

6. Setting up Family settings

Enter your Sky TV PIN.

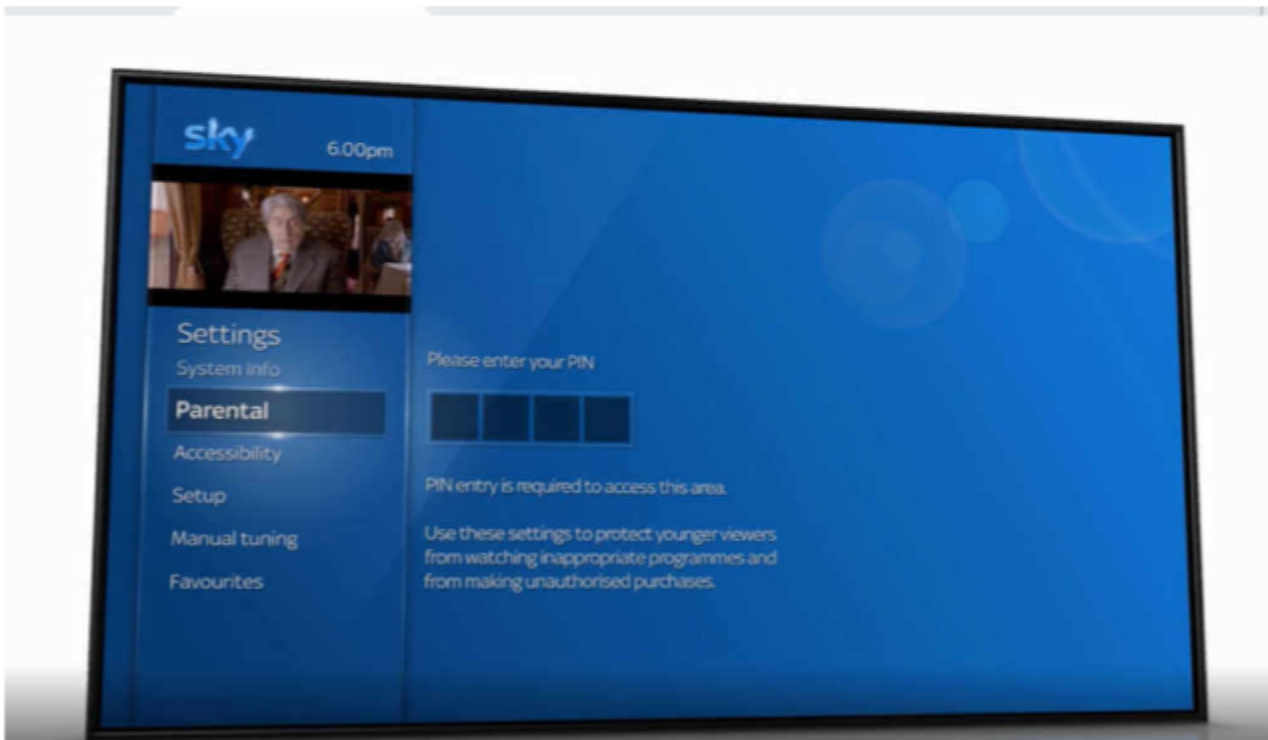

7. Setting up Family settings

Select Family, then Family setting. Select On to PIN-protect all categories listed under Family, or Off to remove the need for a PIN.

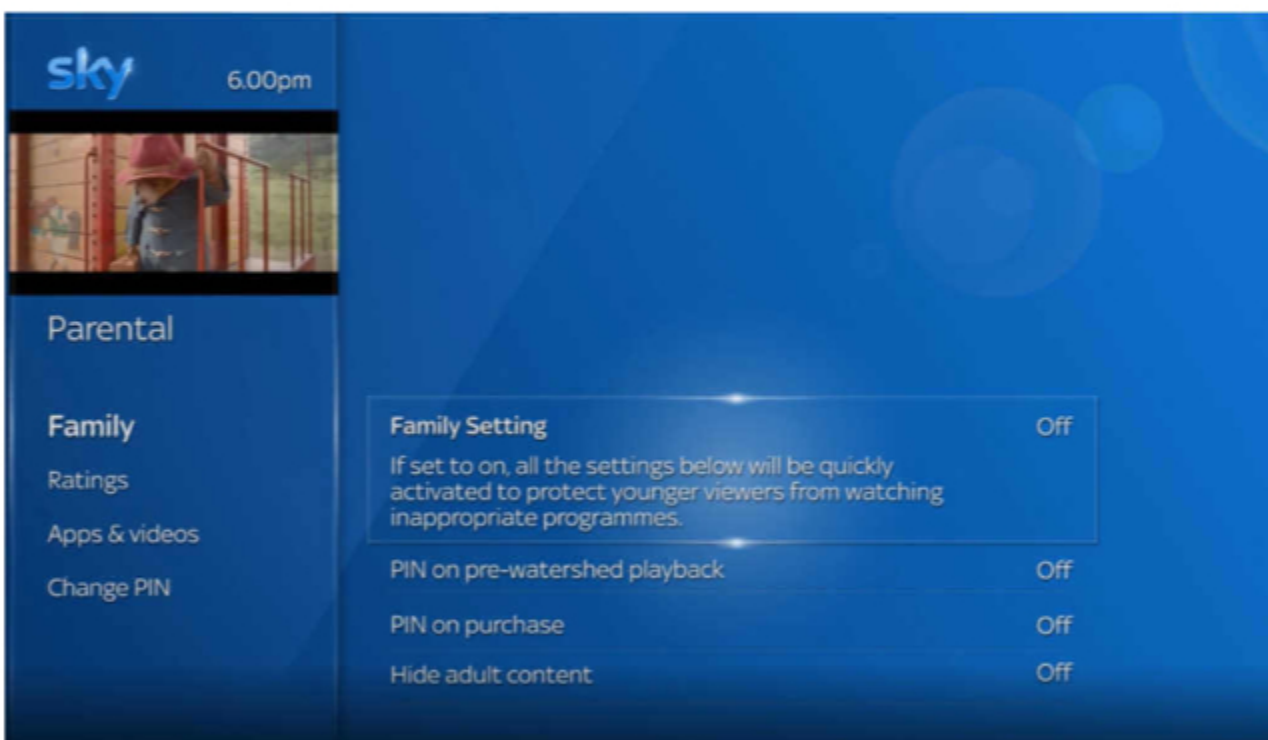

8. Using Age ratings

Go to Age ratings to choose an age rating of shows that will need a pin to be watched



9. Using Apps & videos

Go to Apps & videos to block access to online videos and some apps.

